

Aracaria - Bird Netted Area

Date: 11. 4. 2005

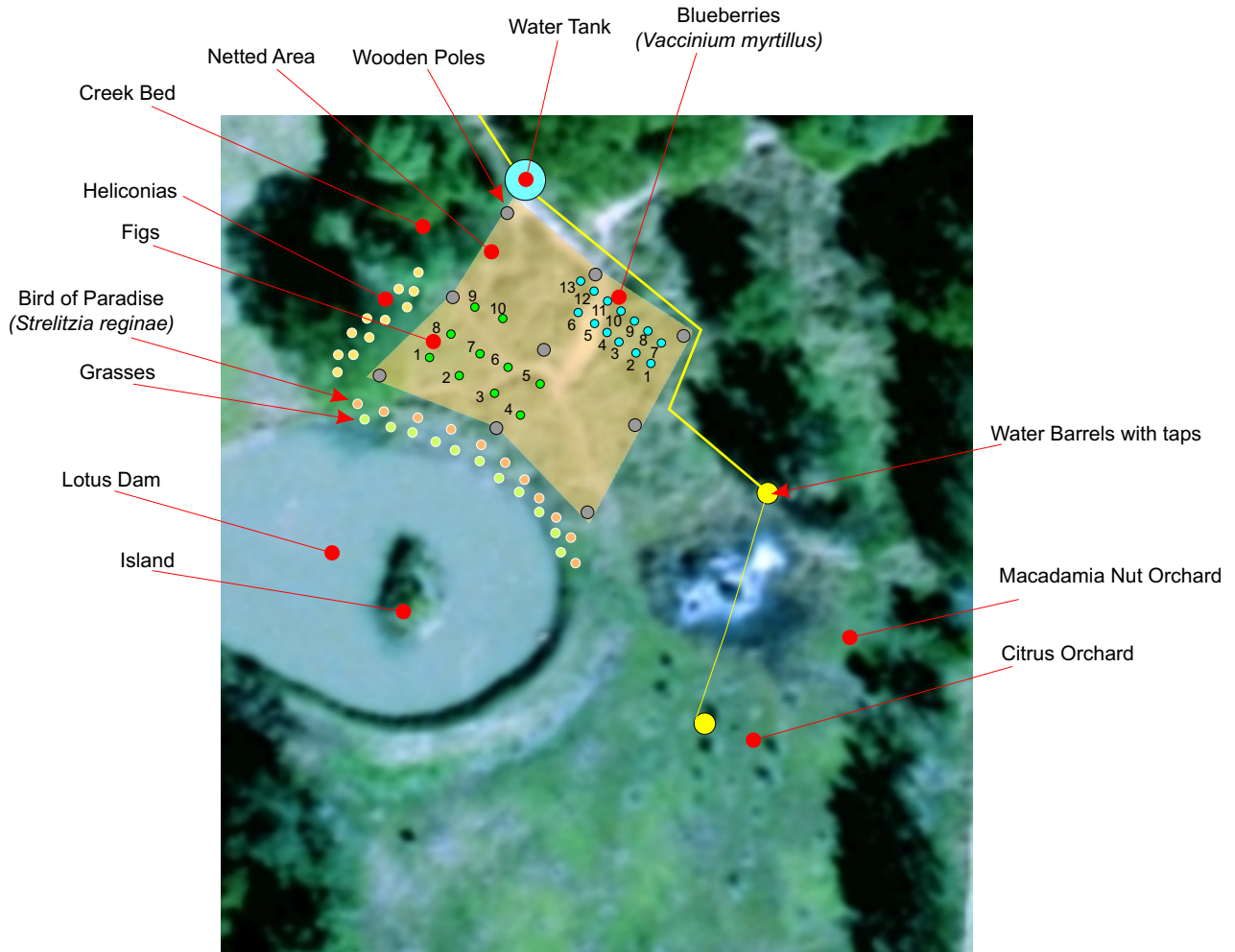

PLANTING METHOD - Blueberries
 Plants purchased at Kyogle nursery.
 Soil: rocky, thin topsoil, clay about 12 inches down.
 cleared weeds and grass in 1m diameter.
 Dug hole, compost, blue metal dust, mulch.
 Planted by: Linda, Stefan, Chris

BLUEBERRY VARIETIES

- 1 - unknown
- 2 - Brightwell
- 3 - Biloxi
- 4 - unknown
- 5 - unknown
- 6 - Sunshine Blue
- 7 - Brightwell
- 8 - Rabbit Eyes - Climax
- 9 - Rabbit Eyes - Climax
- 10 - Sharp Blue
- 11 - Sharp Blue
- 12 - Sharp Blue
- 13 - unknown

RESULTS:

xxx

PLANTING METHOD - FIGS

The figs were originally planted last year (2004).
 Lost three trees during drought.
 Now replaced. Trees come from our own cuttings.

FIG VARIETIES - not known

- 1
- 2
- 3
- 4 - bears 4 figs
- 5 - new
- 6 - new
- 7 - new
- 8
- 9
- 10 - perished

RESULTS:

xxx